

## LE MANS - GARAGE | 25'

1,375 Sq. Ft. (25' x 55') | 14' W x 14' H (Garage Door) | 6+ Car Capacity

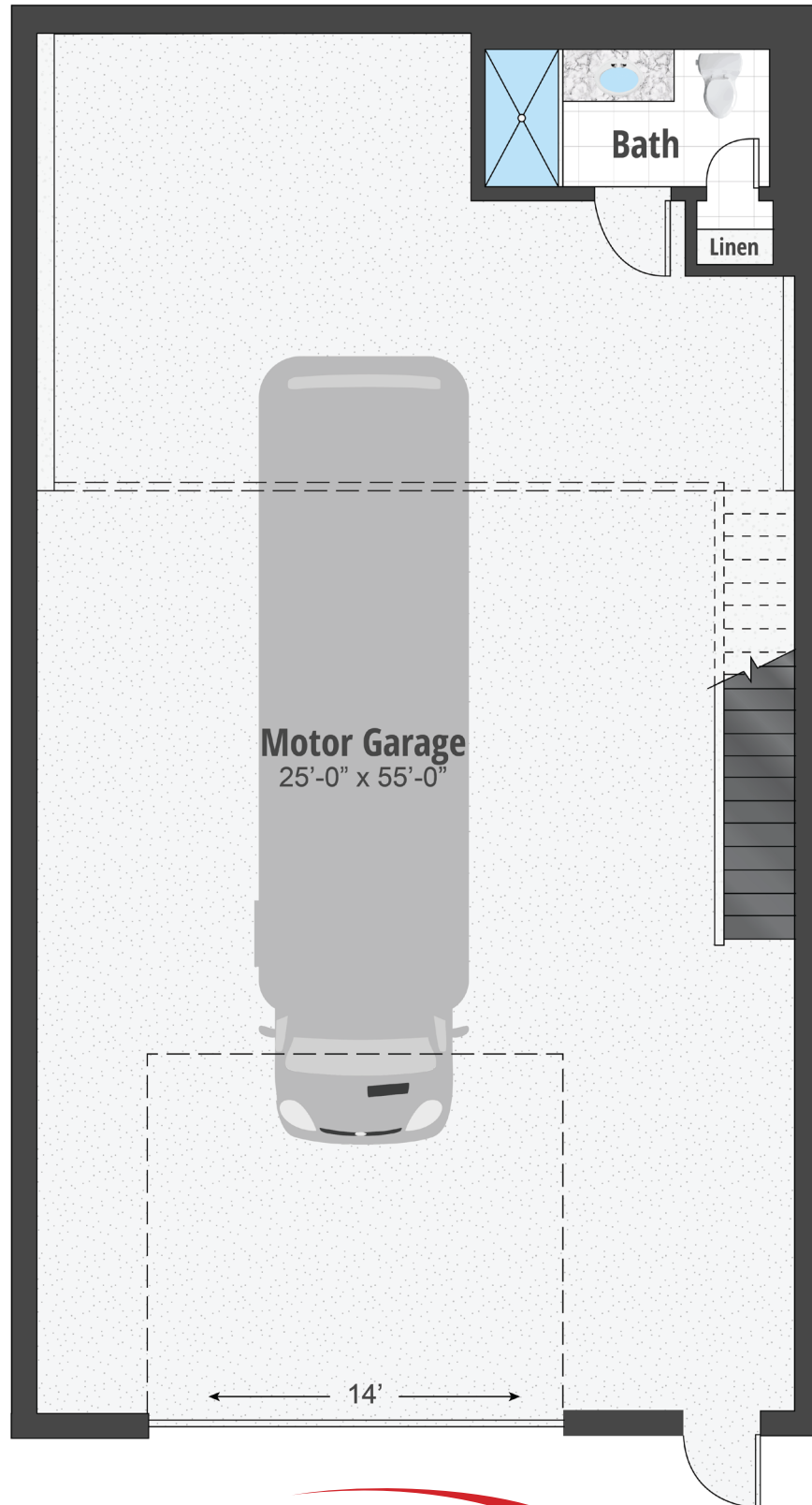

239-422-8589 • SebringResorts.com • 8180 Black Wolf Drive • Sebring, FL 33876



Oral representations should not be relied upon. The images contained in all marketing material are renderings for illustration purposes only. The developer reserves the right to change or alter the architectural features or designs at any time without notice. Prices subject to change without notice. Offered by: Apex Realty Advisors, LLC — Broker.

## LE MANS - MEZZANINE | 25'

450 Sq. Ft. (25' x 18')

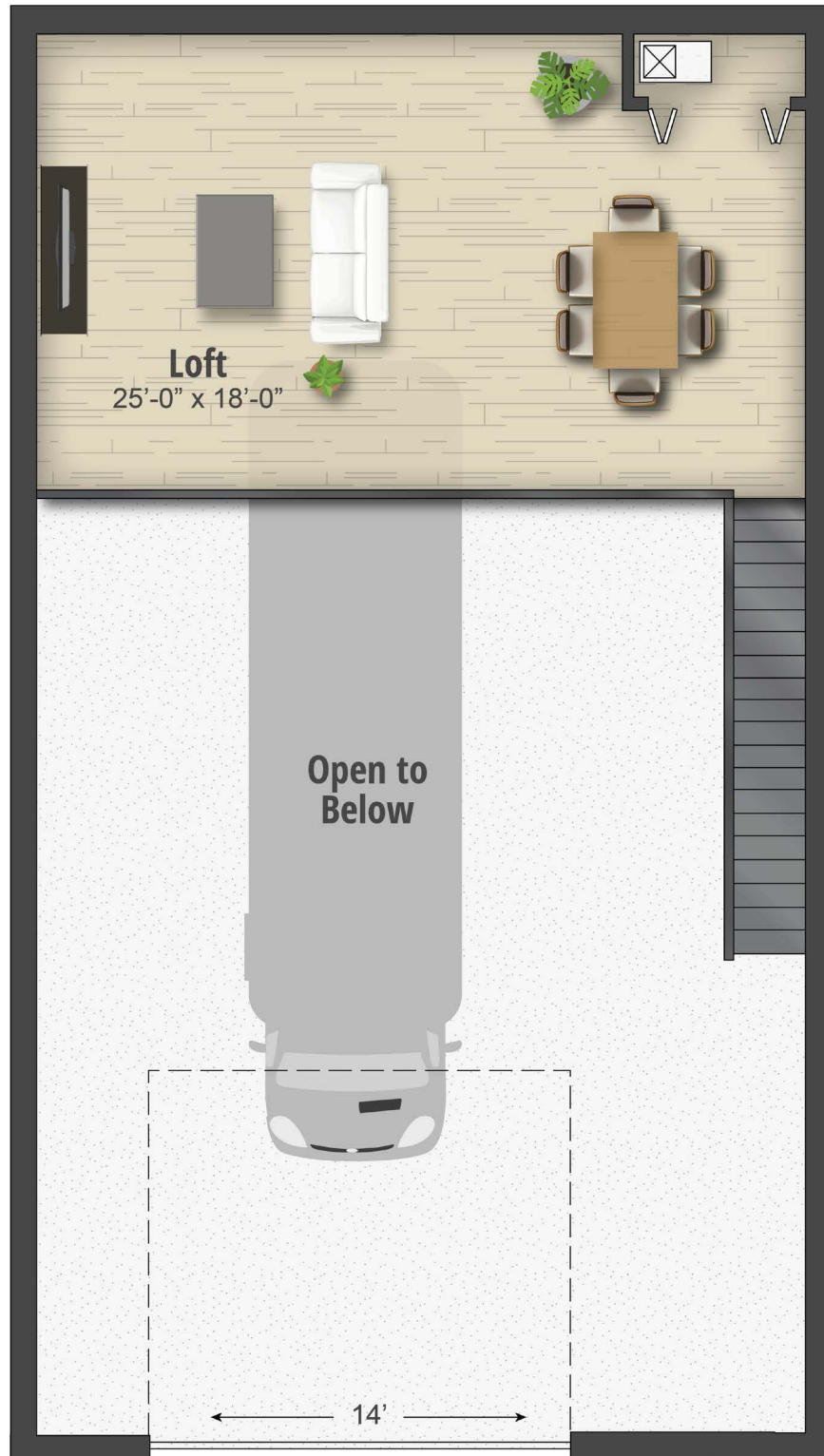

239-422-8589 • SebringResorts.com • 8180 Black Wolf Drive • Sebring, FL 33876



Oral representations should not be relied upon. The images contained in all marketing material are renderings for illustration purposes only. The developer reserves the right to change or alter the architectural features or designs at any time without notice. Prices subject to change without notice. Offered by: Apex Realty Advisors, LLC — Broker.

## LE MANS - SIDE VIEW | 25'

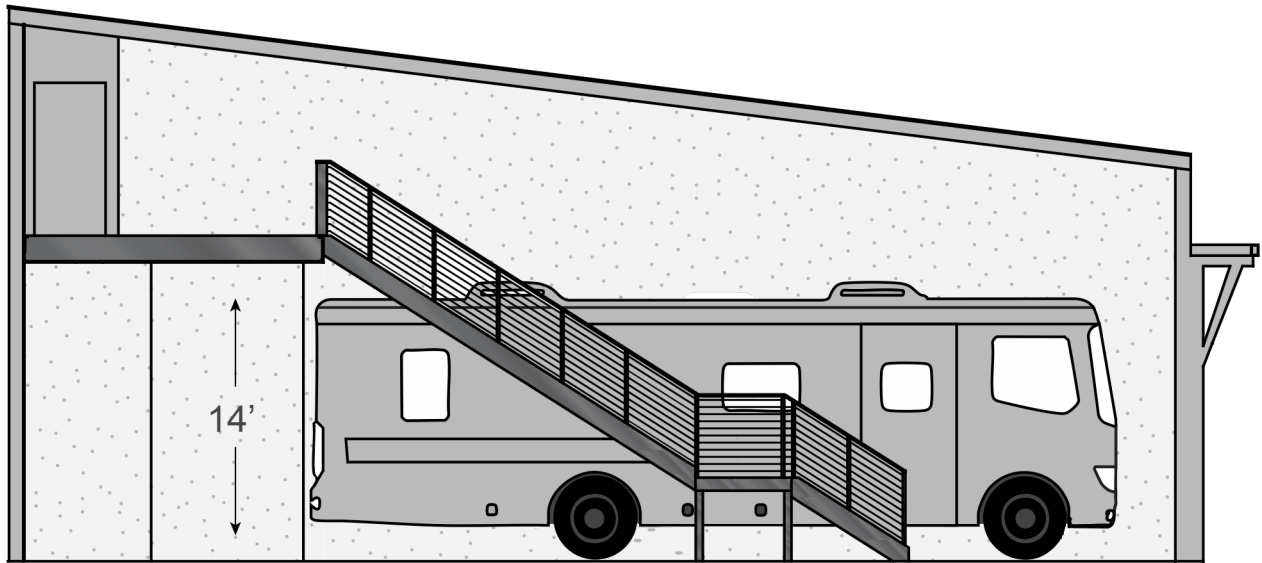
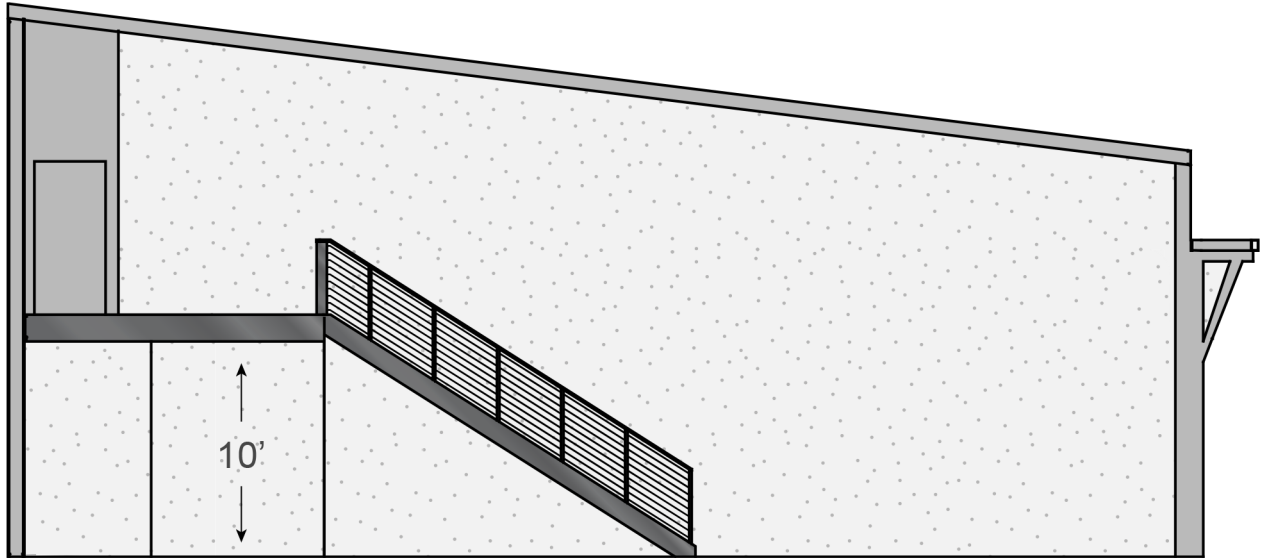

239-422-8589 • [SebringResorts.com](http://SebringResorts.com) • 8180 Black Wolf Drive • Sebring, FL 33876



Oral representations should not be relied upon. The images contained in all marketing material are renderings for illustration purposes only. The developer reserves the right to change or alter the architectural features or designs at any time without notice. Prices subject to change without notice. Offered by: Apex Realty Advisors, LLC — Broker.